



TOTEM PLANTER

TOTEM

STANDING PLANTER / GREEN WALL

project : ZOFIA STRUMIŁŁO - SUKIENNIK
ANNA ŁOSKIEWICZ - ZAKRZEWSKA

The TOTEM planter collection refers to the forms of the Romanian artist Constantin Brâncuși. The repeatability and monumentality of the plant stand modules organizes the space. Plants penetrate its structure, fill it and thus complete the column

Details:

- made of steel
- the ability to choose any color from the RAL palette
- it is possible to customize the planter to the given dimensions
- possibility of preparation for external use
- delivery time 3-5 weeks
- powder coated
- design: Zofia Strumiłło-Sukiennik
and Anna Łoskiewicz-Zakrzewska
- if you have any questions, please write to kontakt@bujnie.pl

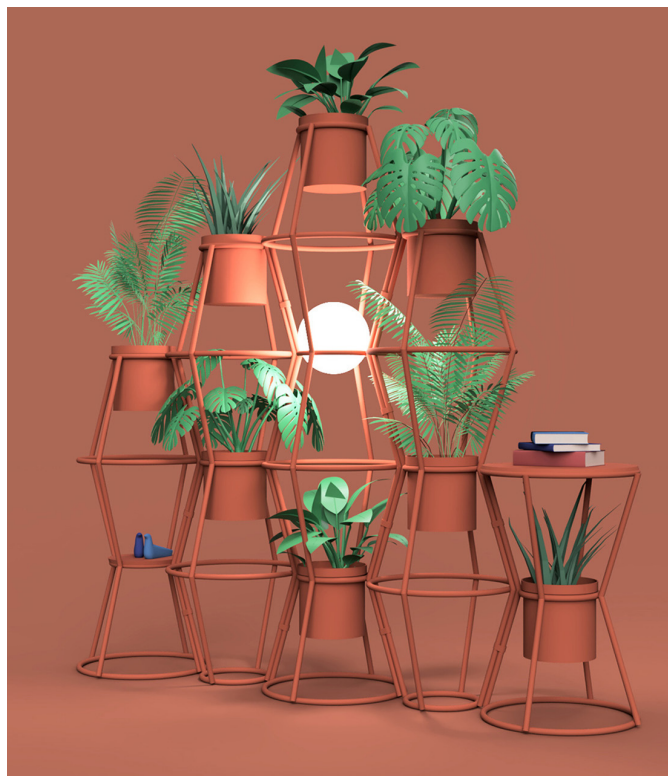

Awards :



2D and 3D files can be downloaded from the website: www.bujnie.pl

Models to choose from:



MODULE FOR 3 PLANTS

Height: 2020 mm
Width: 520 mm
The width of the metal pot: 270 mm



MODULE FOR 2 PLANTS

Height: 1210 mm
Width: 520 mm
The width of the metal pot: 270 mm



MODULE FOR 1 PLANT

Height: 400 mm
Width: 520 mm
The width of the metal pot: 270 mm